



# Shadow Play Quilt

Featuring 85 & Fabulous and Classics by  
Kaffe Fassett Collective

<b>Collection:</b>	85 & Fabulous and Classics by Kaffe Fassett Collective
<b>Technique:</b>	Pieced
<b>Skill Level:</b>	Intermediate
<b>Finished Sizes:</b>	<b>Finished Size:</b> 75 <sup>3</sup> / <sub>4</sub> " x 84" (192.41cm x 213.36cm) <b>Finished Block Size:</b> 11 <sup>1</sup> / <sub>4</sub> " x 11 <sup>1</sup> / <sub>4</sub> " (28.58cm x 28.58cm)

*All possible care has been taken to assure the accuracy of this pattern. We are not responsible for printing errors or the manner in which individual work varies. Please read the instructions carefully before starting this project. If kitting, it is recommended a sample is made to confirm accuracy.*



# Shadow Play Quilt

Project designed by Kaffe Fasset | Tech edited by Alison M. Schmidt

## Fabric Requirements

DESIGN	COLOR	ITEM ID	YARDAGE
<b>(A) Roman Glass</b>	Byza	GP01.BYZA	¼ yard (0.23m)
<b>(B) Paperweight</b>	Pumpkin	GP20.PUMPK	¼ yard (0.23m)
<b>(C) Zinna</b>	Aqua	PWGP031.AQUA	¼ yard (0.23m)
<b>(D) Zinna</b>	Blue	PWGP031.BLUE	½ yard (0.46m)
<b>(E) Zinna</b>	Crimson	PWGP031.CRIMSON	½ yard (0.46m)
<b>(F) Spools</b>	Blue	PWGP034.BLUE*	1 yard (0.91m)
<b>(G) Jumble</b>	Bubble Gum	PWBM053.BUBBLEGUM	¼ yard (0.23m)
<b>(H) Chevron Stripes</b>	Ochre	PWGP090.OCHRE	½ yard (0.46m)
<b>(I) Chevron Stripes</b>	Pink	PWGP090.PINK	½ yard (0.46m)
<b>(J) Chevron Stripes</b>	Red	PWGP090.RED	¼ yard (0.23m)
<b>(K) Millefiore</b>	Antique	PWGP092.ANTIQ	¼ yard (0.23m)
<b>(L) Persian Vase</b>	Black	PWGP100.BLACK	⅔ yard (0.6m)1
<b>(M) Persian Vase</b>	Duck Egg	PWGP100.DUCKEGG	½ yard (0.46m)
<b>(N) Persian Vase</b>	Grey	PWGP100.GREY	½ yard (0.46m)
<b>(O) Persian Vase</b>	Red	PWGP100.RED	¼ yard (0.23m)
<b>(P) Sprays</b>	Brown	PWGP107.BROWN	2⅛ yards (1.94m)
<b>(Q) Sprays</b>	Lime	PWGP107.LIME	¼ yard (0.23m)
<b>(R) Sprays</b>	Red	PWGP107.RED	¼ yard (0.23m)
<b>(S) Large Oriental Trees</b>	Green	PWGP198.GREEN	½ yard (0.46m)
<b>(T) Large Oriental Trees</b>	Maroon	PWGP198.MAROON	½ yard (0.46m)
<b>(U) Large Oriental Trees</b>	Stone	PWGP198.STONE	¼ yard (0.23m)

\* includes binding

## Backing (Purchased Separately)

**44" (1.12m) wide**

Targets Green PWGP067.GREEN 5¾ yards (5.26m)

**OR**

**108" (2.74m) wide**

Pebble Mosaic Prune QBBM004.PRUNE 2¼ yards (2.06m)

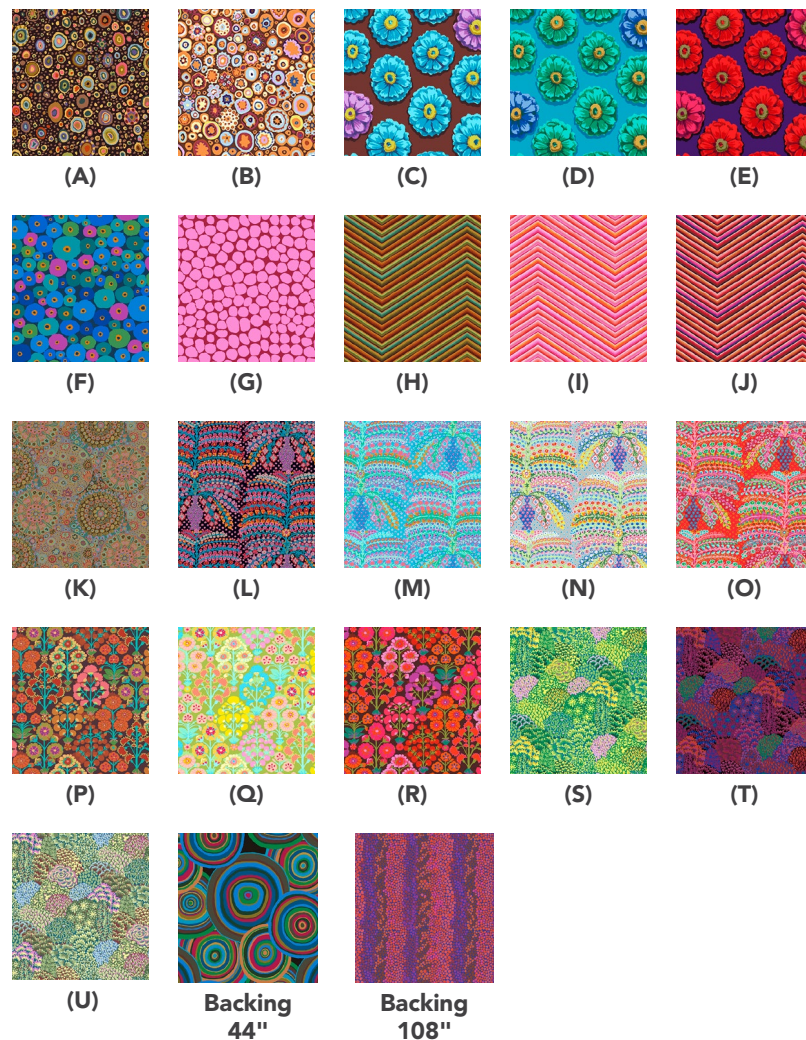

## Additional Recommendations

- 100% cotton thread in colors to match
- 84" x 92" (2.13m x 2.34m) batting

# Shadow Play Quilt

## Cutting

**WOF = Width of Fabric**

### Fabric A, cut:

- (1)  $6\frac{1}{2}$ " x WOF; subcut
- (4)  $6\frac{1}{2}$ " squares

### Fabrics B, C, G, K, O, Q, R and U, cut from each:

- (1)  $6\frac{1}{2}$ " x WOF; subcut
- (6)  $6\frac{1}{2}$ " squares

### Fabrics D, H and M, cut from each:

- (2)  $6\frac{1}{2}$ " x WOF; subcut
- (7)  $6\frac{1}{2}$ " squares

### Fabrics E, I and N, cut from each:

- (2)  $6\frac{1}{2}$ " x WOF; subcut
- (8)  $6\frac{1}{2}$ " squares

### Fabric F, cut:

- (1)  $6\frac{1}{2}$ " x WOF; subcut
- (6)  $6\frac{1}{2}$ " squares
- (9)  $2\frac{1}{2}$ " x WOF for binding

### Fabric J, cut:

- (1)  $6\frac{1}{2}$ " x WOF; subcut
- (5)  $6\frac{1}{2}$ " squares

### Fabric L, cut:

- (3)  $6\frac{1}{2}$ " x WOF; subcut (
- 14)  $6\frac{1}{2}$ " squares

### Fabric P, cut:

- (10)  $6\frac{1}{2}$ " x WOF; reserve
- (9) strips for borders and from 1 strip, subcut
- (6)  $6\frac{1}{2}$ " squares

### Fabric S and T, cut from each:

- (2)  $6\frac{1}{2}$ " x WOF; subcut
- (10)  $6\frac{1}{2}$ " squares

## Instructions

**Note:** Use a  $\frac{1}{4}$ " seam allowance throughout. Sew all pieces with right sides together and raw edges even using matching thread. Press as directed after each seam.

### Block Construction

1. Randomly select 4 different  $6\frac{1}{2}$ " squares, looking for print, color, and value combinations that you enjoy. Try to use 1 or 2 light-value fabrics in the group. There will be extra squares/triangles to allow for more variety when combining prints. **Fig. 1**



**Fig. 1**

2. Cut the 4 squares in half diagonally. **Fig. 2**

**Fig. 2**



3. Arrange all 8 half-square triangles in 2 rows of 4 triangles with the long sides all pointed towards the center, keeping each pair of triangles from the same print square diagonally opposite each other as shown. **Fig. 3**

**Fig. 3**



- Sew the triangles together into 4 half-square triangle (HST) units ( $6\frac{1}{8}$ " square unfinished). Press open to reduce bulk when the block is assembled. **Fig. 4**

**Fig. 4**



- Sew the HST units into rows, pressing the seam allowance in each row in opposite directions. Sew rows together, nesting seam allowances. Make a total of 28 blocks ( $11\frac{3}{4}$ " square unfinished). **Fig. 5**

**Fig. 5**



Make 28 Blocks

- Randomly select 15 of the remaining  $6\frac{1}{2}$ " squares and set aside. Cut all remaining squares in half diagonally.

- Randomly select (2) half-square triangles and one  $6\frac{1}{2}$ " square from those just set aside. Cut the square in half diagonally. Arrange all 4 half-square triangles as shown so the 2 matching triangles are along the long edge. Sew the 2 inner triangles together into an HST unit, press, then add the matching triangles to the adjacent edges, keeping the square corners aligned, to complete a half-block. Press away from center HST. Trim dogears if desired. Staystitch  $\frac{1}{8}$ " from the raw edge along the long bias edge of the block to prevent stretching. Make a total of 15 half-blocks ( $12\frac{3}{8}$ " x  $12\frac{3}{8}$ " unfinished). **Fig. 6**

**Fig. 6**



Make 15 Half-Blocks

- Randomly select (2) half-square triangles. Sew triangles together along 1 short side as shown. Press. Staystitch along both short sides of the unit to prevent stretching. Make a total of 2 quarter-blocks ( $9\frac{1}{4}$ " x  $9\frac{1}{4}$ " unfinished). **Fig. 7**

**Fig. 7**



Make 2  
Quarter-Blocks

## Quilt Top Assembly

- Noting the **Quilt Layout** diagram (page 6), arrange the blocks, half-blocks, and quarter-blocks in 9 diagonal rows (the last row is made up of only one quarter-block). Sew the blocks into diagonal rows, pinning at seam intersections to match seams. Sew diagonal rows together.
- Sew all the reserved **Fabric P** strips together end-to-end using straight seams. Cut 2 side border strips 90" long and 2 top/bottom border strips 82" long.
- Center a side border on the right-hand side of the quilt center, pin and stitch starting and stopping  $\frac{1}{4}$ " from corners of quilt center. Do not trim. Repeat to add the top border. Press borders away from the quilt center. **Fig. 8**

**Fig. 8**

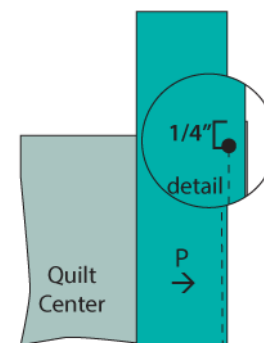

- 12.** Fold the quilt right sides together so the outside edges of the 2 borders line up. Using the 45° line on a ruler, mark from the end of border seams to outer edges of borders. Stitch along marked line. Open up and check that the quilt top is flat, then trim seam allowance to  $\frac{1}{4}$ ". Press corner seam open.

**Fig. 9**

**Fig. 9**

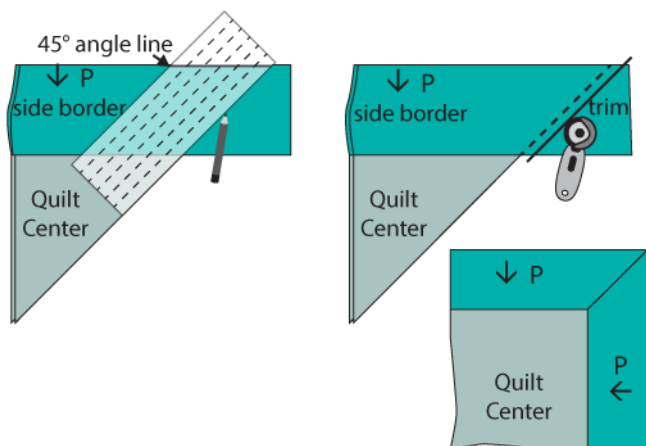

- 13.** Repeat steps 11 and 12 to add the bottom and left side borders and miter all remaining corners.

## Finishing

- 14.** Sew together the  $2\frac{1}{2}$ " **Fabric F** binding strips end-to-end using diagonal seams. Press seams open. Press the binding strip in half wrong sides together.
- 15.** Layer backing (wrong side up), batting, and quilt top (right side up). Baste the layers together and quilt as desired. Trim excess batting and backing even with the top after quilting is completed.
- 16.** Leaving an 8" tail of binding, sew the binding to the top of the quilt through all layers matching all raw edges. Miter corners. Stop approximately 12" from where you started. Lay both loose ends of binding flat along quilt edge. Where the loose ends meet, fold them back on themselves and press to form a crease. Using this crease as your stitching line, sew the two open ends of the binding right sides together. Trim seam to  $\frac{1}{4}$ " and press open. Finish sewing binding to quilt.
- 17.** Turn the binding to the back of quilt and hand-stitch in place.



## Quilt Layout

